

Part Description	Part No.	Material	Finishing	REV.
142 SERIES CENTRONIC CONNECTOR RIGHT ANGLE TYPE	OYS-142-XX-X-X-X-X	Refer to Note	Refer To Note	0

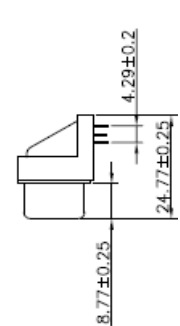

Dimensions

Positions	A	B	C	D
14	12.96	25.6	36.0	43.9
24	23.76	36.3	46.8	54.7
36	36.72	49.3	59.6	67.7
50	51.84	64.4	74.9	82.8

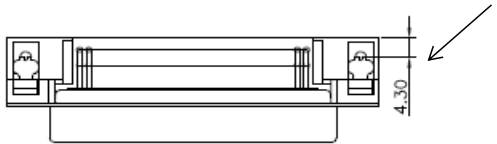
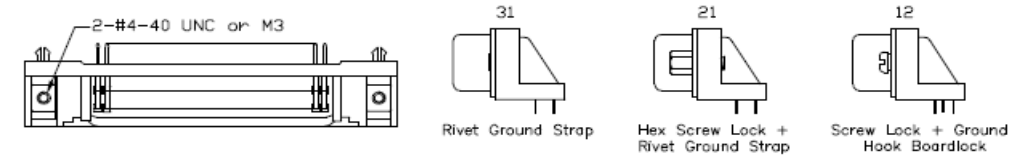
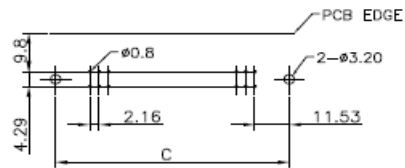
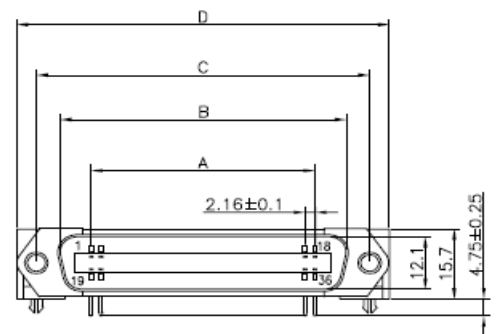

Centronic P.C.B Right Angle Male Rivet Type & Ground Hook

P.C.B Layout

How To Order

Ordering Information

142 - $\frac{XX}{a} \frac{X}{b} \frac{X}{c} \frac{X}{d} \frac{X}{e} \frac{X}{f}$

- a. No. of Contacts
14, 24, 36, 50
- b. Contact Type
1: Male
2: Female
- c. Contact Plating
1: Selective Gold
2: 15u'
3: 30u'
- d. Insulator Color
1: Blue
2: Black
- e. Special Function
1: #4-40 Pan Screw (Standard)
2: #4-40 Hex Screw (4.75 x 11.8)
3: #4-40 Square Rivet Insert
4: M3 Rivet Insert
- f. Special Function
1: Ground strap(Both With #4-40 UNC Thread)
2: Ground Hook(Front #4-40 UNC Thread)

ANY DOUBTFUL PLEASE ASK. DO NOT PROCEED IF DOUBTFUL NOT CLEAR.

NOTES:

- 1. ELECTRICAL CHARACTERISTICS:-
 - a) Temperature: -55°C to +105°C
 - b) Current Rating: 1 AMP
 - c) Dielectric Strength: AC 1000V Min for 1 minute
 - d) Insulation Resistance: 1000 MΩ MIN at 500 VDC
 - e) Contact Resistance: 25 m MAX mated

3	Insulator	PBT & Glass- fiber reinforced UL-94-V0		
2	Pin Contact	Phosphor Bronze/ Gold plated		
1	Shell	Steel		
No	Part Name	Part Material	Qty for Assy	Remarks

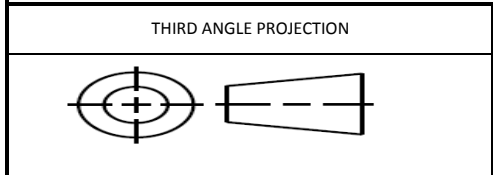

DRAWN BY	CHECKED BY	APPROVED BY
----------	------------	-------------

ALL DIMENSION ARE IN MM
DATE: 16-12-2015



Part Description	Part No.	Material	Finishing	REV.
142 SERIES CENTRONIC CONNECTOR RIGHT ANGLE TYPE	OYS-142-XX-X-X-X-X	Refer to Note	Refer To Note	0

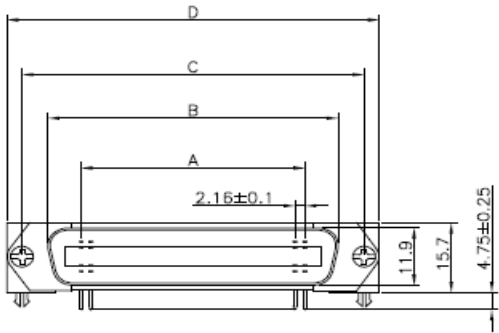
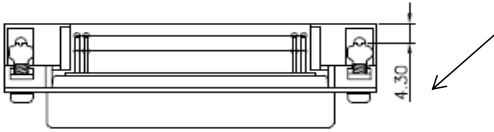
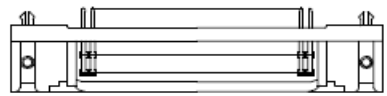

57 Centronic P.C.B Right Angle Female Ground Hook Screw Lock

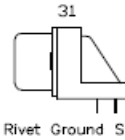

31 Rivet Ground Strap

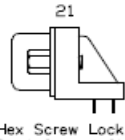

21 Hex Screw Lock + Rivet Ground Strap

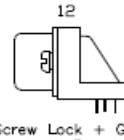

12 Screw Lock + Ground Hook Boardlock

Dimensions

Positions	A	B	C	D
14	12.96	25.6	36.0	43.9
24	23.76	36.3	46.8	54.7
36	36.72	49.3	59.6	67.7
50	51.84	64.4	74.9	82.8

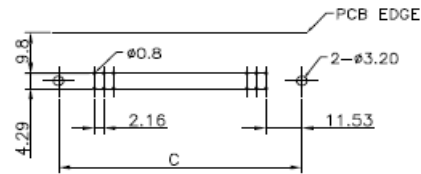
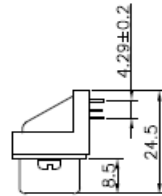

P.C.B Layout



How To Order

Ordering Information

142 - $\frac{XX}{a} \frac{X}{b} \frac{X}{c} \frac{X}{d} \frac{X}{e} \frac{X}{f}$

- a. No. of Contacts
14, 24, 36, 50
- b. Contact Type
1: Male
2: Female
- c. Contact Plating
1: Selective Gold
2: 15u"
3: 30u"
- d. Insulator Color
1: Blue
2: Black
- e. Special Function
1: #4-40 Pan Screw (Standard)
2: #4-40 Hex Screw (4.75 x 11.8)
3: #4-40 Square Rivet Insert
4: M3 Rivet Insert
- f. Special Function
1: Ground strap(Both With #4-40 UNC Thread)
2: Ground Hook(Front #4-40 UNC Thread)

ANY DOUBTFUL PLEASE ASK. DO NOT PROCEED IF DOUBTFUL NOT CLEAR.

NOTES:

1. ELECTRICAL CHARACTERISTICS:-
 - a) Temperature: -55°C to +105°C
 - b) Current Rating: 1 AMP
 - c) Dielectric Strength: AC 1000V Min for 1 minute
 - d) Insulation Resistance: 1000 MΩ MIN at 500 VDC
 - e) Contact Resistance: 25 m MAX mated

3	Insulator	PBT & Glass- fiber reinforced UL-94-V0		
2	Pin Contact	Phosphor Bronze/ Gold plated		
1	Shell	Steel		
No	Part Name	Part Material	Qty for Assy	Remarks

THIRD ANGLE PROJECTION

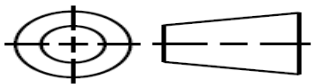

ALL DIMENSION ARE IN MM

DRAWN BY
CHECKED BY
APPROVED BY

DATE: 16-12-2015

