

Part Description	Part No.	Material	Finishing	REV.
187 SERIES IEEE 1394 CONNECTOR SOCKET RIGHT ANGLE TYPE	OYS-187-062012	Refer to Note	Refer To Note	0

How To Order

Ordering Information

187 - $\frac{XX}{a}$ $\frac{X}{b}$ $\frac{X}{c}$ $\frac{X}{d}$ $\frac{X}{e}$

- a. No. Of Pins
06: 06 positions
- b. Contact Type
1: Male
2: Female
- c. Contact Plating
0: Gold flash selective gold
1: 15u" selective gold over 50u" nickel
2: 30u" selective gold over 50u" nickel
3: 50u" selective gold over 50u" nickel
- d. Shell Plating
1: Nickel
2: Tin
- e. Insulator Color
1: White
2: Black

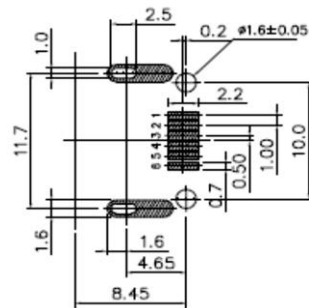
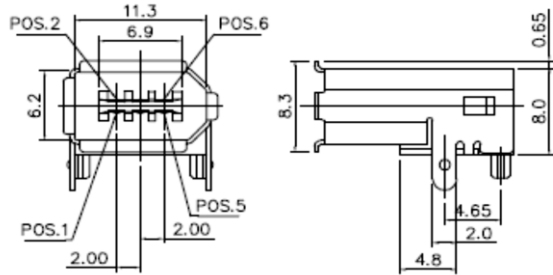
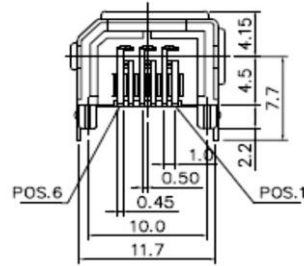
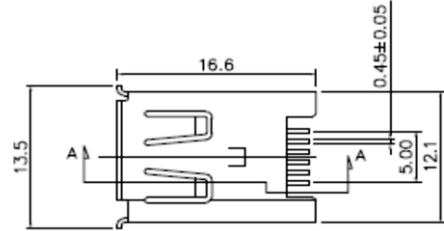

P.C.B Footprint

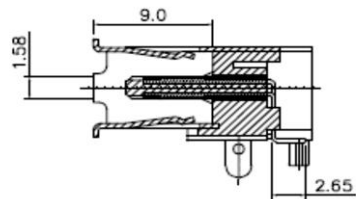

Section A-A

ANY DOUBTFUL PLEASE ASK. DO NOT PROCEED IF DOUBTFUL NOT CLEAR.

NOTES:

1. ELECTRICAL CHARACTERISTICS:-

- a) Contact Resistance : 30MΩ MAX at 1 AMP DC
- b) Dielectric Withstanding Voltage : 750 VAC/r.m.s. 60 Hz for 1 minute
- c) Insulation Resistance : 1000 mΩ min at 500 VDC

3	Shell	Phosphor Bronze		
2	Contact	Phosphor Bronze		
1	Housing	PBT & Glass-Fiber, UL-94V-0		
No	Part Name	Part Material	Qty for Assy	Remarks



THIRD ANGLE PROJECTION

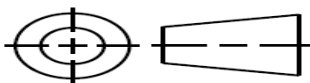

DRAWN
BY

CHECKED
BY

APPROVED
BY

DATE: 16-12-2015

ALL DIMENSION
ARE IN MM

